

**CITY OF BEAVERTON
DESIGN EXCEPTION REQUEST**

<i>For City Engineering Office use only</i>	
Control No:	

Project Name:		FC/ROW/SD/CIP #:	
Project Location:			

PROJECT DATA

Functional Classification:	<input type="checkbox"/> Arterial <input type="checkbox"/> Collector <input type="checkbox"/> Neighborhood Route <input type="checkbox"/> Local <input type="checkbox"/> Other			
Current ADT (Year):		Design ADT (Year):		
Posted Speed:	mph	Design Speed:	mph	Anticipated Approval Date:
Funding:	<input type="checkbox"/> Private <input type="checkbox"/> City <input type="checkbox"/> State <input type="checkbox"/> Federal			
Current Estimate:		Additional Cost to Meet Standard:		
NHS:	<input type="checkbox"/>	Top 10% SPIS Site:	Yes	<input type="checkbox"/>
Non NHS:	<input type="checkbox"/>		No	<input type="checkbox"/>

Design Exceptions for which version: 2007 <input type="checkbox"/> 2019 <input type="checkbox"/>		
<input type="checkbox"/> Design Speed	<input type="checkbox"/> Lane Width	<input type="checkbox"/> Bridge Rail
<input type="checkbox"/> Horizontal Alignment	<input type="checkbox"/> Parking Width	<input type="checkbox"/> Pavement Design Life
<input type="checkbox"/> Vertical Alignment	<input type="checkbox"/> Bike Lane/Multi-Use Path Width	<input type="checkbox"/> Vertical Clearance
<input type="checkbox"/> Intersection Sight Distance	<input type="checkbox"/> Median Width	<input type="checkbox"/> Super elevation
<input type="checkbox"/> Stopping Sight Distance	<input type="checkbox"/> Length of Cul-de-sac	<input type="checkbox"/> Super elevation Runoff
<input type="checkbox"/> Intersection / Driveway Spacing	<input type="checkbox"/> Shy Distance	<input type="checkbox"/> Clear Zone
<input type="checkbox"/> Pavement Cross Slope	<input type="checkbox"/> ADA Standards	<input type="checkbox"/> (Other)
<input type="checkbox"/> Grade	<input type="checkbox"/> Bridge Width	Sidewalk Width ¹

¹ Needs a Sidewalk Modification from Planning.

Description of Project:

Description of Exception:

Location of Design Feature:

Reasons For Not Attaining Standard: (Such As Cost/ Benefit, Crash History, Environmental, Etc.)

Effect on Other Standards:

Compatibility with Adjacent Sections and Context:

Mitigation for Exception Included In Design:

Supporting Documentation (Include the appropriate Plan Section, Cross Section, Alignments Sheets & Plan Details):

**CITY OF BEAVERTON
DESIGN EXCEPTION REQUEST**

Signatures

Prepared By: _____ **Date:** _____
(Engineer of Record)

Print Name:		Phone:	
Company Name:			
Company Address:			
City:		ST:	
Email Address:			

Concurred By: _____ **Date:** _____
(Site Development Division Manager, Public Works Director,
OPS Program Manager, etc.)

(Print Name)

Concurred By: _____ **Date:** _____
(City Traffic Engineer)

(Print Name)

Approved By: _____ **Date:** _____
(City Engineer)

(Print Name)

PREPARED BY:

**ENGINEER OF RECORD
PROFESSIONAL
ENGINEER STAMP**



G:\PDX_Projects\19\2519 - Beaverton Non-Potable Program\CAD\Sheets\19-2519-OR-C.dwg FIG 1 4/9/2021 4:12 PM LEA.CONNORS 23.0s (LMS Tech)

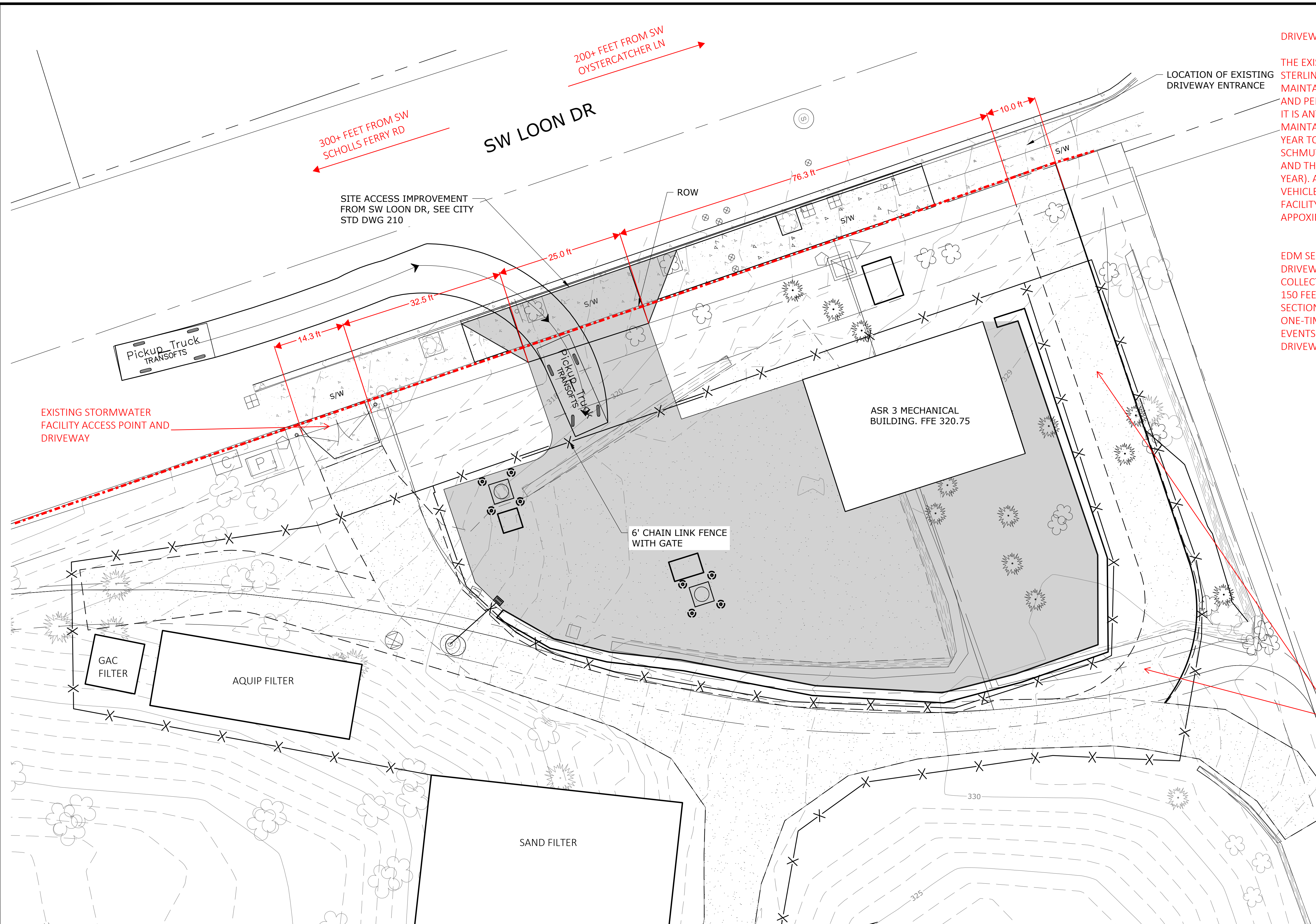

DRIVEWAY USE NARRATIVE:

THE EXISTING DRIVEWAYS (NORTH AND SOUTH) FOR ACCESS TO STERLING PARK STORMWATER FACILITY ARE PROPOSED TO BE MAINTAINED AS ACCESS POINTS TO THE STORMWATER FACILITY AND PERIODIC ACCESS TO THE STERLING PARK TREATMENT SYSTEM. IT IS ANTICIPATED THAT THE DRIVEWAYS WILL ONLY BE USED TO MAINTAIN THE TREATMENT SYSTEM TWO OR THREE TIMES PER YEAR TO SERVICE THE SAND FILTER (REMOVAL OF TOP LAYER OR SCHMUTZDECKE), AQUIP FILTER (REPLACE MEDIA, ONCE PER YEAR) AND THE GAC FILTER (GRANULAR ACTIVATE CARBON, ONCE PER YEAR). ALL OTHER MAINTENANCE ACTIVITIES WILL NOT REQUIRE VEHICLE ACCESS VIA THESE DRIVEWAYS. THE PROPOSED ASR FACILITY ACCESS DRIVEWAY WILL BE USED TO ACCESS THE SITE APPROXIMATELY 3 TIMES PER WEEK UNDER NORMAL OPERATIONS.

EDM SECTION 210.21.C AND E REQUIRES CORNER CLEARANCES OF DRIVEWAYS AND DRIVEWAY SPACING ON ARTERIALS AND COLLECTORS WITH 25 MPH DESIGN SPEED TO BE A MINIMUM OF 150 FEET. IN ACCORDANCE WITH THE CITY OF BEAVERTON EDM SECTION 160.1.A, WE REQUEST THAT THE CITY APPROVE A ONE-TIME EXCEPTION TO THE CITY STANDARD GIVEN THE RARE EVENTS FOR ACCESS AND USE OF THE NORTH AND SOUTH DRIVEWAY ACCESS POINTS.

PLAN
SCALE: 1"=10'

NO.	DATE	BY	REVISION

NOTICE

0 1/2 1

IF THIS BAR DOES NOT MEASURE 1" THEN DRAWING IS NOT TO SCALE

KMV
DESIGNED
CAD
DRAWN
CHK
CHECKED

PRELIMINARY ONLY
DO NOT USE FOR CONSTRUCTION

MARCH 2021

Murraysmith
www.murraysmith.us



SITE PLAN

PROJECT NO.: 19-2519 SCALE: AS SHOWN DATE: MARCH 2020

SHEET

FIG 1

X of X