

A G E N D A B I L L

Beaverton City Council
Beaverton, Oregon

91-118

SUBJECT: INVENTORY OF
HISTORIC TREES

FOR AGENDA OF: 5/20/91 BILL NO. 91-118

APPROVED FOR AGENDA BY: *AAA*

DEPT. OF ORIGIN: PLANNING DIVISION *JD*

DATE SUBMITTED: APRIL 30, 1991

PROCEEDING: CONSENT AGENDA

CLEARANCES:

EXHIBITS: REPORT DATED MARCH 7, 1991
HRRC MINUTES DATED APRIL 18, 1991

EXPENDITURE	AMOUNT	APPROPRIATION
REQUIRED: \$ 0	BUDGETED \$ 0	REQUIRED \$ 0

BACKGROUND

On April 18, 1991, the Historic Resource Review Committee approved the attached list of sites as containing historic trees.

RECOMMENDED ACTION

Approve on Consent Agenda.

F2730S

TO: Historic Resource Review Committee DATE: March 7, 1991
FROM: Nadine M. Smith
 Senior Planner
RE: Historic Tree Inventory

A. Background

The City Council recently adopted an amendment to Ordinance 2050 addressing tree and vegetation preservation. One of the requirements of that ordinance amendment was as follows:

"An inventory shall be conducted of trees or groves which may qualify as historic. After drawing up a proposed list of historic trees and groves of trees, the Historic Resource Review Committee (HRRRC) shall hold at least one public hearing of which the affected property owners have been notified, pursuant to the procedures of Section 130. Each property owner of the tree or trees under consideration shall be notified by certified mail 30 days prior to any public hearing.

"Following public hearing, the HRRRC shall develop a recommended list of historic trees and groves. The Council may adopt the recommended list on its consent agenda or may hold a public hearing in the same manner and form as the hearing held by the HRRRC. Any affected party may request a hearing before the City Council prior to adoption."
(Section 265(A and B), Ordinance 2050)

Using the adopted list of historic resources in Beaverton and following research to determine the existence of historic trees in Beaverton, approximately 50 sites were evaluated for potential historic designation.

Historic trees are defined in the ordinance as "those designated by the City to be of historic significance based upon their association with historic figures, properties or general growth and development of the City.

Historic Tree Inventory

March 7, 1991

Page 2 of 3

Prior to completion of the inventory, Neighborhood Association were contacted for their input and staff appeared before most associations to provide information on the ordinance and inventory process.

B. Historic Tree Inventory

The final proposed historic tree inventory consists of a total of six sites. Attached to this report is a summary sheet on each of the sites. Historic trees will be evaluated by the City's Historic Resource Review Committee as a separate public hearing process.

C. Ordinance Regulation of Trees on the Inventory

Those trees finally adopted as historic will require Historic Resource Review Committee approval for removal. If development is proposed that will impact an individual historic tree, a public hearing will be required before the Historic Resource Review Committee to evaluate the impact on the tree or trees. Trees may be removed if the HRRRC finds that the circumstances listed under Section 263 of the Ordinance have been met or the tree has lost its historic significance for some reason.

The ordinance will also regulate pruning of historic trees. A permit from the Planning Department is required for pruning. The permit will require that pruning take place in such a way that will not damage or kill the protected tree.

D. HRRRC Action

Staff held a public information meeting on February 7th to meet with individuals who are proposed for the inventory and address individual concerns. As of the preparation of this report, the Planning Department has received one letter of opposition to listing on the inventory which is attached.

It is our intent to give a presentation at the public hearing on March 7th on the individual sites that are proposed to be listed as containing historic trees. Unless further information is required, the Historic Resource Review Committee can adopt the historic inventory at that hearing.

The inventory that is adopted by the Committee will appear on the City Council's consent agenda for final adoption. An optional public hearing date has also been provided for a hearing before Council.

Historic Tree Inventory
March 7, 1991
Page 3 of 3

E. Recommendation

Staff recommends that the Historic Resource Review Committee adopt following trees as historic trees:

1. Ponderosa pine located at 4875 SW Angel
2. Sequoias located at 4440 SW 148th (St. Mary's Academy)
3. Birches located at 16270 SW Hart Road
4. Oak located at 10010 SW 125th
5. Landscaping at Merle Davies Elementary school on SW Farmington
6. "Century trees" at Fanno Farm house in the Creekside industrial park.

Attachments

1. Section 260 - 272 of Ordinance 2050 (Preservation of Trees and Vegetation)
2. Inventory Forms and public responses

Historic Trees # 1

BEAVERTON TREE INVENTORY

ADDRESS: 4875 SW Angel

CROSS STREETS: 4th ST, NW Corner

LOT SIZE: _____

Number of trees over 3" DBH
(DBH: Diameter at breast height)
Formula for DBH

Diameter = Circumference divided by pi (3.1416)

- Historic Potential
Species:
- 1. Big leaf Maple (4)
 - 2. Ponderosa Pine
 - 3.
 - 4.
 - 5.
 - 6.
 - 7.

- 8.
- 9.
- 10.
- 11.
- 12.
- 13.
- 14.

Groves - number of trees _____ Average DBH _____
Number of Street Trees
Define street trees

Draw lot showing corresponding trees from above list:

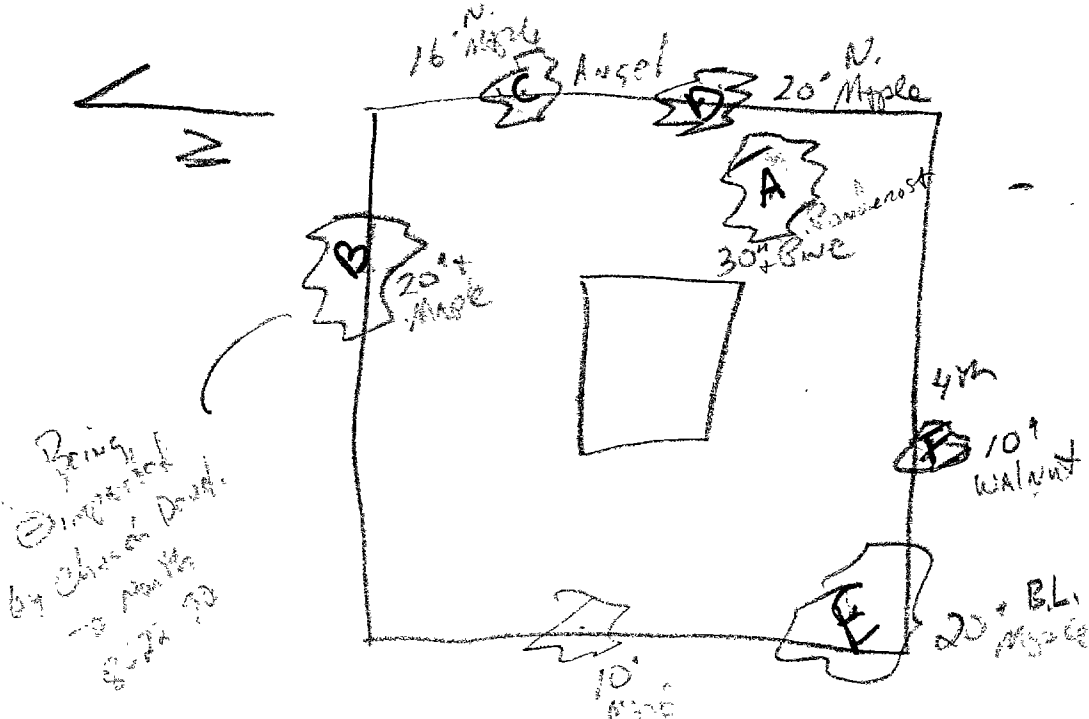

BEAVERTON TREE INVENTORY
 TREE/GROVE HISTORICAL RATING SHEET

RATING SCALE:

1. - No historical value.
Age 20 years or under.
2. - Little historical value.
Age 20 years or over.
3. - Some historical value.
Age 50 years or over.
4. - Has historical value
Age 80 years or over.
5. - Has significant historical value.
Age 100 years or over.

CONDITION ASSESSMENT:

1. - Poor condition
Unhealthy with parts dead
or dying.
2. - Fair condition - OK health
but needing care.
3. - Good condition - Healthy.
(May still need care)

LOCATION 4875 SW Angel

	<u>AGE</u>	<u>CONDITION</u>	
A	5	3	} stressed from recent const.
B	4	1-2	
C	3	1-2	
D	3	2	
E	4	3	
F	1	3	

TREE/GROVE HISTORICAL ANALYSIS:

- 1) Tree/Grove association with historic figures, events or significantly associated with a location, place or structure.

RATING RATING RATING

A 5 _____ _____

Comments: Ponderosa pine of significant age. The historic Cady structure constructed was ~~located~~ to after the tree indicating that the tree was ~~dead~~ preserved during construction. Cady was an important figure in Beavertons growth and development

- 2) Tree/Grove association with general growth and development of the City.

_____ _____ _____

Comments: _____

TOTAL

5 _____ _____

Historic Trees # 2

BEAVERTON TREE INVENTORY

ADDRESS: ST MARKS (EAST side)

CROSS STREETS: 148th TU

LOT SIZE: _____

Number of trees over 3" DBH
(DBH: Diameter at breast height)
Formula for DBH

Diameter = Circumference divided by pi (3.1416)

- Species:
- | | |
|---------------------|-----|
| 1. OAKS 30" C + P | |
| 2. Pond Pines 30" O | 8. |
| 3. Redwoods 50" A | 9. |
| 4. Oregon Ash 20" Q | 10. |
| 5. | 11. |
| 6. | 12. |
| 7. | 13. |
| | 14. |

Groves - number of trees _____ Average DBH _____
Number of Street Trees _____
Define street trees _____

Draw lot showing corresponding trees from above list:

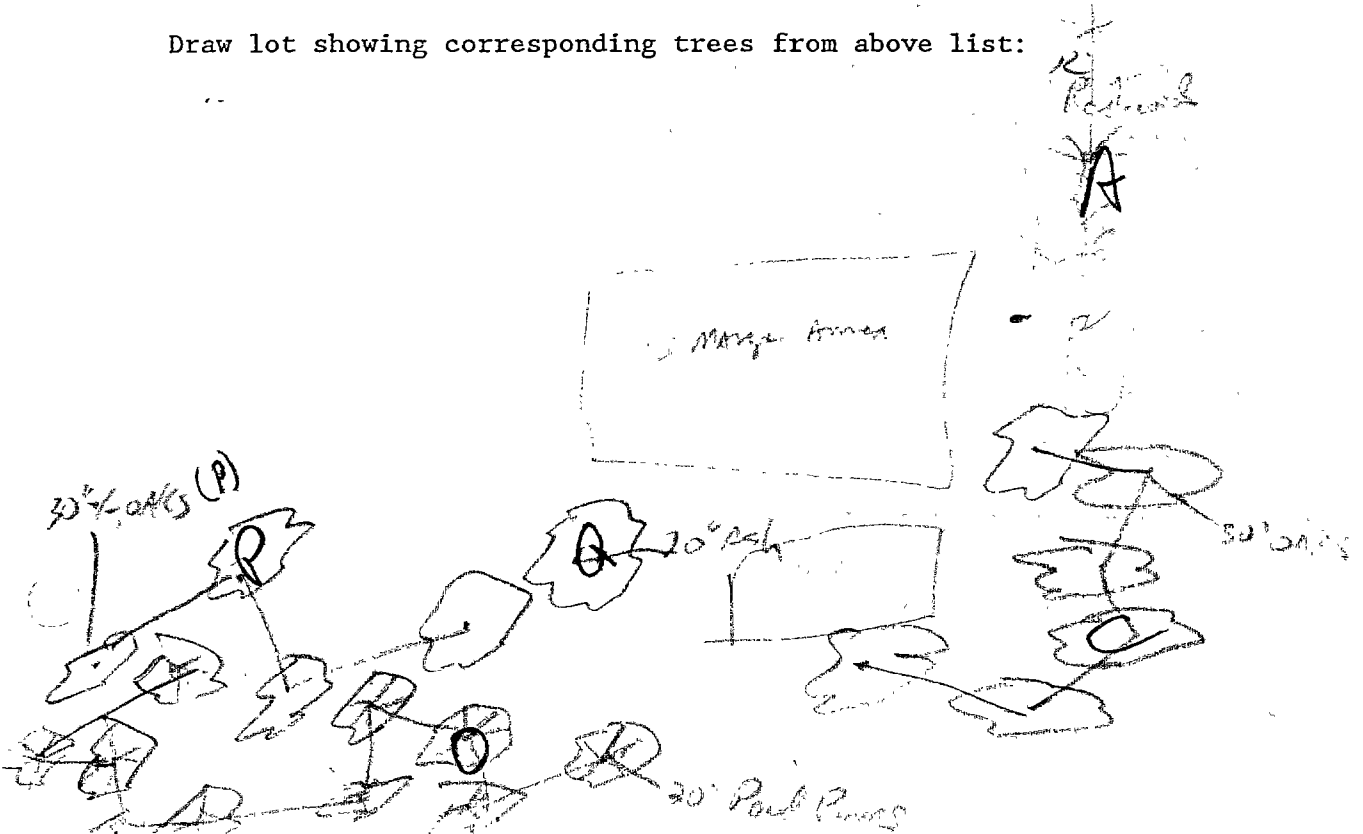

BEAVERTON TREE INVENTORY
 TREE/GROVE HISTORICAL RATING SHEET

RATING SCALE:

1. - No historical value.
Age 20 years or under.
2. - Little historical value.
Age 20 years or over.
3. - Some historical value.
Age 50 years or over.
4. - Has historical value
Age 80 years or over.
5. - Has significant historical value.
Age 100 years or over.

CONDITION ASSESSMENT:

1. - Poor condition
Unhealthy with parts dead or dying.
2. - Fair condition - OK health but needing care.
3. - Good condition - Healthy.
(May still need care)

LOCATION 4440 SW 148th

	<u>AGE</u>	<u>CONDITION</u>
H	3 (70yrs)	3
I	3	2
J	2 (40yrs)	2
K	3	2-3
L	3	2-3
M	2 (40yrs)	2

TREE/GROVE HISTORICAL ANALYSIS:

- 1) Tree/Grove association with historic figures, events or significantly associated with a location, place or structure.

<u>RATING</u>	<u>RATING</u>	<u>RATING</u>
<u>5</u>	_____	_____

Comments: The landscaping at St. Mary's Academy is intrical to the grandeur of the building setting.

- 2) Tree/Grove association with general growth and development of the City.

<u>5</u>	_____	_____
----------	-------	-------

Comments: The mature trees are associated with the structure that is a landmark in the City

TOTAL 10 _____

BEAVERTON TREE INVENTORY
TREE/GROVE HISTORICAL RATING SHEET

RATING SCALE:

- 1. - No historical value.
Age 20 years or under.
- 2. - Little historical value.
Age 20 years or over.
- 3. - Some historical value.
Age 50 years or over.
- 4. - Has historical value
Age 80 years or over.
- 5. - Has significant historical value.
Age 100 years or over.

CONDITION ASSESSMENT:

- 1. - Poor condition
Unhealthy with parts dead
or dying.
- 2. - Fair condition - OK health
but needing care.
- 3. - Good condition - Healthy.
(May still need care)

LOCATION 4440 SW 148th

	<u>AGE</u>	<u>CONDITION</u>
A	<u>5</u>	<u>3</u>
B	<u>5</u>	<u>3</u>
C	<u>5</u>	<u>3</u>
D	<u>3 (70yrs)</u>	<u>3</u>
E	<u>5</u>	<u>3</u>
F	<u>5</u>	<u>3</u>
G	<u>3 (70yrs)</u>	<u>3</u>

TREE/GROVE HISTORICAL ANALYSIS:

- 1) Tree/Grove association with historic figures, events or significantly associated with a location, place or structure.

<u>RATING</u>	<u>RATING</u>	<u>RATING</u>
<u>3</u>	_____	_____

Comments: Redwoods associated with historic location

- 2) Tree/Grove association with general growth and development of the City.

<u>2</u>	_____	_____
----------	-------	-------

Comments: _____

TOTAL

_____	_____	_____
-------	-------	-------

RECEIVED
FEB 11 1991
PLANNING DEPARTMENT

The Sisters of St. **MARY** *of Oregon*

February 7, 1991

Nadine Smith
City of Beaverton
4755 SW Griffith Drive
P. O. Box 4755
Beaverton, OR 97076

Dear Ms. Smith,

On behalf of the Sisters of St. Mary of Oregon, I would like to express concern about inclusion of St. Mary of the Valley in the City's significant tree inventory.

In recent telephone conversations, you have indicated to Sister Delores Adelman and Kevin Van Hoomissen that our convent building is designated as a historic site and that trees and landscaping around it are your prime interest.

Please be advised that we share the intent of such interest. The Sisters of St. Mary of Oregon have occupied this site for more than 100 years--(we received the J. Arthur Young Award from the Beaverton Chamber in 1985 on the occasion of our Centennial)--and have maintained our campus with pride during that time. Most of the trees and shrubs were planted by the Sisters themselves with the necessary attention to cultivation and pruning. The area surrounding the Convent is a visual blessing in our area, and it is our intention to keep it that way.

We feel that inclusion in the City's significant tree inventory could result in regulation of tree pruning and/or removal of what your inventory would identify as "mature trees."

In your telephone conversations with us, you have cited certain circumstances which would soften the impact of restrictive regulatory requirements; these include safety hazards, damaged trees, access to buildings or equipment, and coping with water drainage, etc.

We find all of these problems in our current site management scenario, as we search for ways to safely improve access/egress from our site, improve on-site traffic and parking, provide for new campus programs, and accommodate new surface water requirements, while maintaining our existing site functions of education and health care.

We respectfully ask that no unnecessary administrative hurdles be placed in the way of the achievement of our plan and programs. Therefore, we request that our trees not be placed on the City's significant tree inventory at this time.

4440 Southwest 148th · Beaverton, Oregon 97007

We pledge our continued cooperation in helping to keep Beaverton beautiful.
Our century in Beaverton should make that pledge credible.

Sincerely,

Sister Anna Hertel

Sister Anna Hertel
Superior General

BEAVERTON TREE INVENTORY
TREE/GROVE HISTORICAL RATING SHEET

RATING SCALE:

1. - No historical value.
Age 20 years or under.
2. - Little historical value.
Age 20 years or over.
3. - Some historical value.
Age 50 years or over.
4. - Has historical value
Age 80 years or over.
5. - Has significant historical value.
Age 100 years or over.

CONDITION ASSESSMENT:

1. - Poor condition
Unhealthy with parts dead or dying.
2. - Fair condition - OK health but needing care.
3. - Good condition - Healthy.
(May still need care)

LOCATION 4490 SW 148th

	<u>AGE</u>	<u>CONDITION</u>	
N	<u>5</u>	<u>2 + 1</u>	(20+ks)
O	<u>5</u>	<u>3</u>	
P	<u>5</u>	<u>3</u>	
Q	<u>3</u>	<u>2</u>	
R	<u>3</u>	<u>3</u>	
S	<u>3</u>	<u>3</u>	

TREE/GROVE HISTORICAL ANALYSIS:

- 1) Tree/Grove association with historic figures, events or significantly associated with a location, place or structure.

Comments: _____

- 2) Tree/Grove association with general growth and development of the City.

Comments: _____

RATING RATING RATING

TOTAL

Historic Trees # 3

MAP #

BEAVERTON TREE INVENTORY
TREE/GROVE HISTORICAL RATING SHEET

RATING SCALE:

- 1. - No historical value.
Age 20 years or under.
- 2. - Little historical value.
Age 20 years or over.
- 3. - Some historical value.
Age 50 years or over.
- 4. - Has historical value
Age 80 years or over.
- 5. - Has significant historical value.
Age 100 years or over.

CONDITION ASSESSMENT:

- 1. - Poor condition
Unhealthy with parts dead
or dying.
- 2. - Fair condition - OK health
but needing care.
- 3. - Good condition - Healthy.
(May still need care)

<u>AGE</u>	<u>CONDITION</u>
A 3	3
_____	_____
_____	_____

All 6 same
Age +/-
+ Condition

LOCATION 16270 SW Hart

TREE/GROVE HISTORICAL ANALYSIS:

- 1) Tree/Grove association with historic figures, events or significantly associated with a location, place or structure.

<u>RATING</u>	<u>RATING</u>	<u>RATING</u>
4	_____	_____

Comments: Trees associated with
historic figure and the
general growth of the City

- 2) Tree/Grove association with general growth and development of the City.

Comments: _____

TOTAL

_____	_____	_____
-------	-------	-------

LINDA DAVIS
BEAVERTON PLANNING DIRECTOR
CITY OF BEAVERTON
4755 SW GRIFFITH DR
BEAVERTON, OR 97005

H4

DEAR LINDA;

THIS IS A REQUEST FOR PLACEMENT OF THE 6 (SIX) WEEPING BIRCH TREES LOCATED ON MY PROPERTY UPON THE INVENTORY LIST OF HISTORICAL AND SIGNIFICANT TREES TO BE PROTECTED UNDER THE PROPOSED TREE ORDINANCE.

MY PROPERTY ADDRESS IS 16270 SW HART ROAD, MORE SPECIFICALLY DESCRIBED AS LOT 1 OF WEEPING BIRCH ESTATES. SINCE THESE ARE THE ONLY BIRCH TREES ON THESE DEVELOPED LOTS, THEY ARE OBVIOUSLY THE NAMESAKES FOR THIS AREA.

I RESIDE IN THE OLD HART HOMESTEAD FOR WHICH HART ROAD IS NAMED. THESE TREES WERE PLANTED IN THE EARLY 1940'S BY MR ROSS HART AS A PROPERTY BARRIER FROM THE ROAD, WHICH WAS UNPAVED AT THAT TIME. MR HART WAS A LEADING CITIZEN OF THE CITY OF BEAVERTON AND INVOLVED IN MANY CIVIC PURSUITS. HE WAS A TRUE ENTREPRENEUR; WITH A HATCHERY U-PICK STRAWBERRY FIELDS (APPROX 18 ACRES) AND TALENT AGENCY ALL RUN FROM THIS LOCATION.

THIS PROPERTY, ALONG WITH THE AFORE-MENTIONED TREES, ARE A SIGNIFICANT PART OF THE HISTORY OF THIS CITY. MY WIFE AND I HAVE TAKEN GREAT PRIDE IN THE RESTORATION OF THIS HOME AND WOULD LIKE TO HAVE THE PROPERTY UPON WHICH IT SITS PROTECTED AND PRESERVED AS WELL.

A FEW YEARS AGO, WE LED THE FIGHT AGAINST A LOCAL IMPROVEMENT DISTRICT PROPOSED BY WASHINGTON COUNTY TO WIDEN HART ROAD. WE AND OUR SUPPORTIVE NEIGHBORS SUCCESSFULLY DEFEATED THIS INITIATIVE, NOT BECAUSE OF THE PLAN TO WIDEN THIS MAJOR COLLECTOR STREET (WHICH WE MAY SUPPORT), BUT PRIMARILY DUE TO THE PLAN CALLING FOR THE REMOVAL OF THESE TREES. RATHER THAN WIDENING THE STREET TO THE MOSTLY UNDEVELOPED NORTH SIDE, THE PLAN CALLED FOR AN ABANDONMENT OF PROPERTY MOSTLY TO THE SOUTH. THIS WAS UNACCEPTABLE TO EACH OF US AND WAS SUBSEQUENTLY DEFEATED.

BASED UPON THE ABOVE-SUBMITTED INFORMATION, I RESPECTFULLY REQUEST PROTECTION FOR THESE MAJESTIC TREES, IN ORDER THAT THEY REMAIN A PART OF THE HERITAGE OF BEAVERTON.

RESPECTFULLY SUBMITTED,

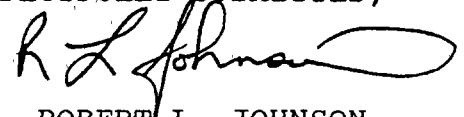
A handwritten signature in black ink, appearing to read "R L Johnson", with a large, sweeping flourish at the end.

ROBERT L. JOHNSON

PS: IF YOU WOULD BE SO KIND AS TO DISTRIBUTE THE ENCLOSED COPIES,
I WOULD APPRECIATE IT VERY MUCH.

CC: CITY COUNCIL MEMBERS
KAREN JAMES--CHAIRWOMAN OF THE COMMITTEE
TO SAVE BEAVERTON TREES

BEAVERTON TREE INVENTORY

ADDRESS: 16270 SW Hart Rd

CROSS STREETS: West of 162 South Side of Hart

LOT SIZE: _____

Number of trees over 3" DBH
(DBH: Diameter at breast height)
Formula for DBH

Diameter = Circumference divided by pi (3.1416)

- Species:
- | | |
|----------------------|-----|
| 1. 6-20+ white Birch | |
| 2. | 8. |
| 3. | 9. |
| 4. | 10. |
| 5. | 11. |
| 6. | 12. |
| 7. | 13. |
| | 14. |

Groves - number of trees _____ Average DBH _____
Number of Street Trees _____
Define street trees _____

Draw lot showing corresponding trees from above list:

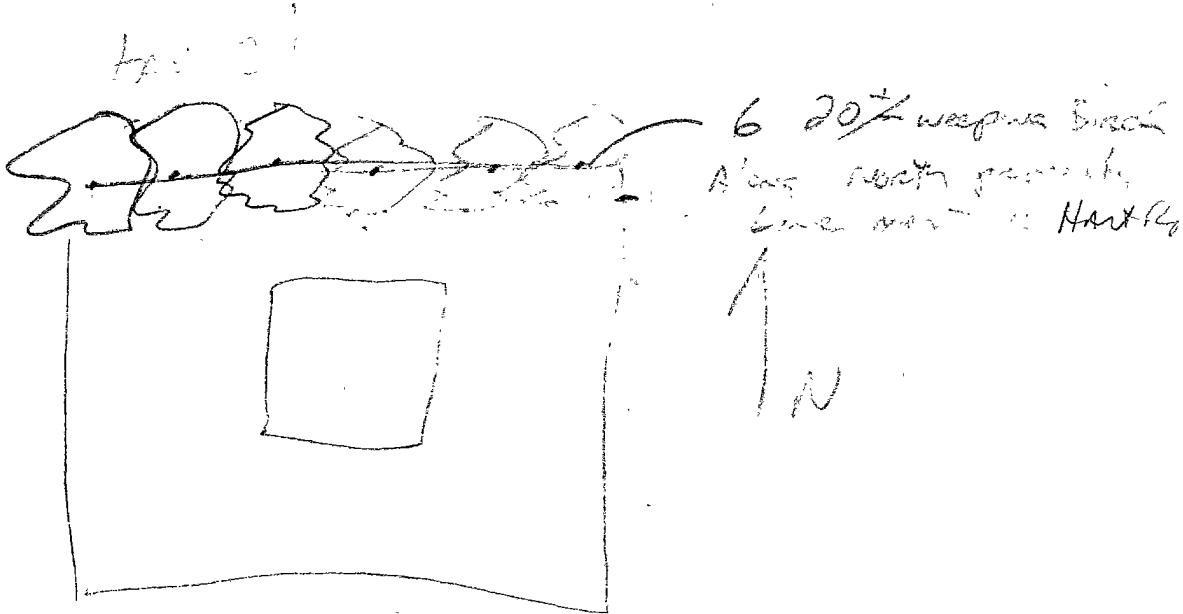

Historic Tree # 4

BEAVERTON TREE INVENTORY

ADDRESS: 10010 SW 125th - (Sorrento)

CROSS STREETS: SE corner with Conestoga

LOT SIZE: _____

Number of trees over 3" DBH
(DBH: Diameter at breast height)
Formula for DBH

Diameter = Circumference divided by pi (3.1416)

Potential Historic

Species:

- | | |
|------------------------------|-----|
| 1. 2 OAKS | |
| 2. 10" Oregon (Calf.) Laurel | 8. |
| 3. Norway Spruce 14" | 9. |
| 4. | 10. |
| 5. | 11. |
| 6. | 12. |
| 7. | 13. |
| | 14. |

Groves - number of trees _____ Average DBH _____
Number of Street Trees _____
Define street trees _____

Draw lot showing corresponding trees from above list:

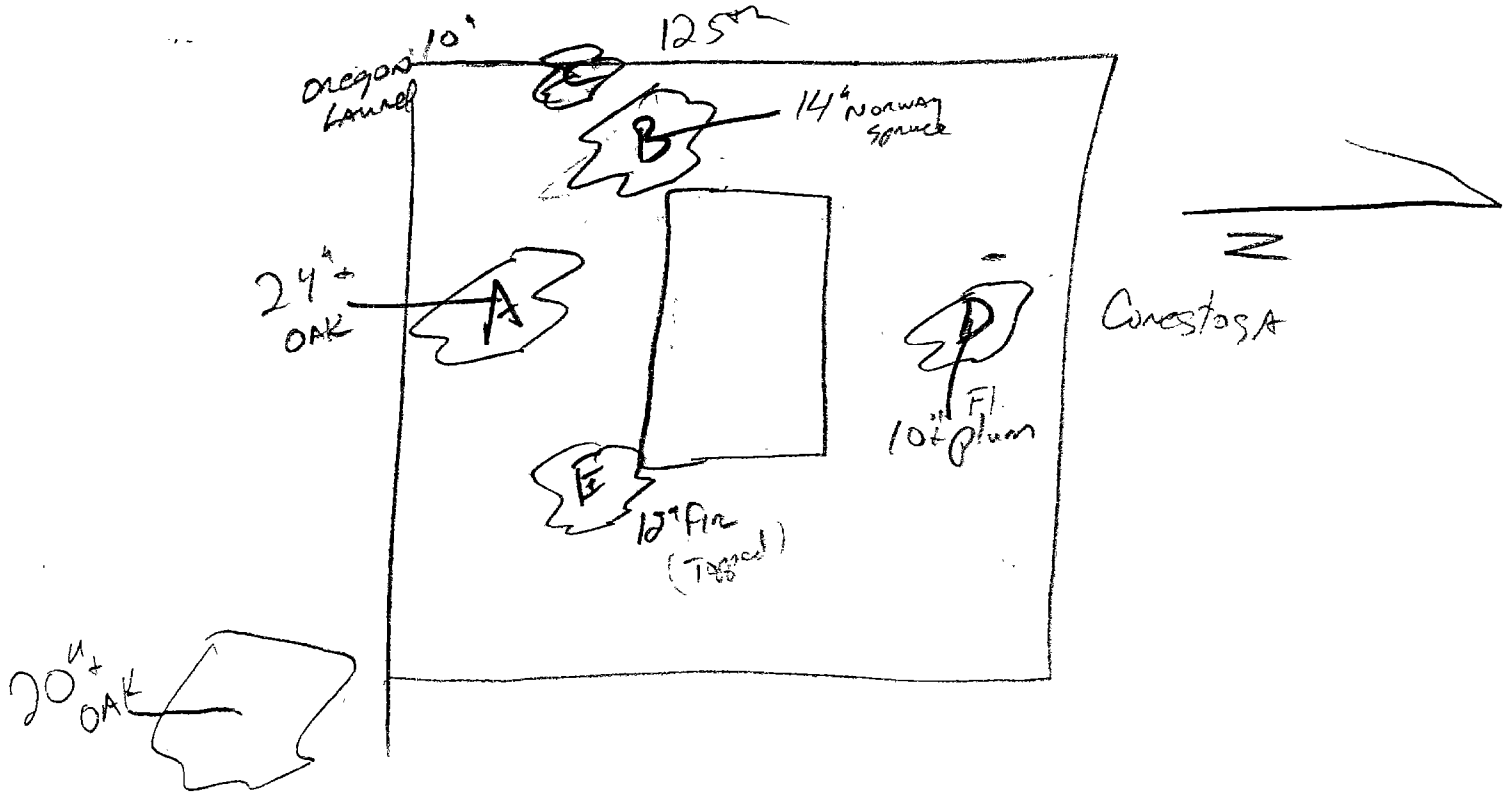

BEAVERTON TREE INVENTORY
TREE/GROVE HISTORICAL RATING SHEET

RATING SCALE:

- 1. - No historical value.
Age 20 years or under.
- 2. - Little historical value.
Age 20 years or over.
- 3. - Some historical value.
Age 50 years or over.
- 4. - Has historical value
Age 80 years or over.
- 5. - Has significant historical value.
Age 100 years or over.

CONDITION ASSESSMENT:

- 1. - Poor condition
Unhealthy with parts dead or dying.
- 2. - Fair condition - OK health but needing care.
- 3. - Good condition - Healthy.
(May still need care)

AGE CONDITION

A	<u>4</u>	<u>2</u>	
B	<u>2</u>	<u>3</u>	
C	<u>2 (40yrs)</u>	<u>3</u>	
D	<u>2 (40yrs)</u>	<u>3</u>	
E	<u>2 (40yrs)</u>	<u>2/3</u>	Topped c 40'

LOCATION 10010 SW Sorrento (125th)

TREE/GROVE HISTORICAL ANALYSIS:

RATING RATING RATING

- 1) Tree/Grove association with historic figures, events or significantly associated with a location, place or structure.

3 _____ _____

Comments: The 20" + caliper oak
is of an age that it is
associated with the site of
the Hiteen School

- 2) Tree/Grove association with general growth and development of the City.

Comments: The oak as part of an
early school site is associated
with Beaverton

TOTAL

Historic tree # 5

BEAVERTON TREE INVENTORY

ADDRESS: 13150 Farmington

CROSS STREETS: _____

LOT SIZE: _____

Number of trees over 3" DBH
(DBH: Diameter at breast height)
Formula for DBH

Diameter = Circumference divided by pi (3.1416)

Potential Historic

Species:

- 1. N Maple
- 2.
- 3.
- 4.
- 5.
- 6.
- 7.
- 8.
- 9.
- 10.
- 11.
- 12.
- 13.
- 14.

Groves - number of trees _____ Average DBH _____

Number of Street Trees

Define street trees

Draw lot showing corresponding trees from above list:

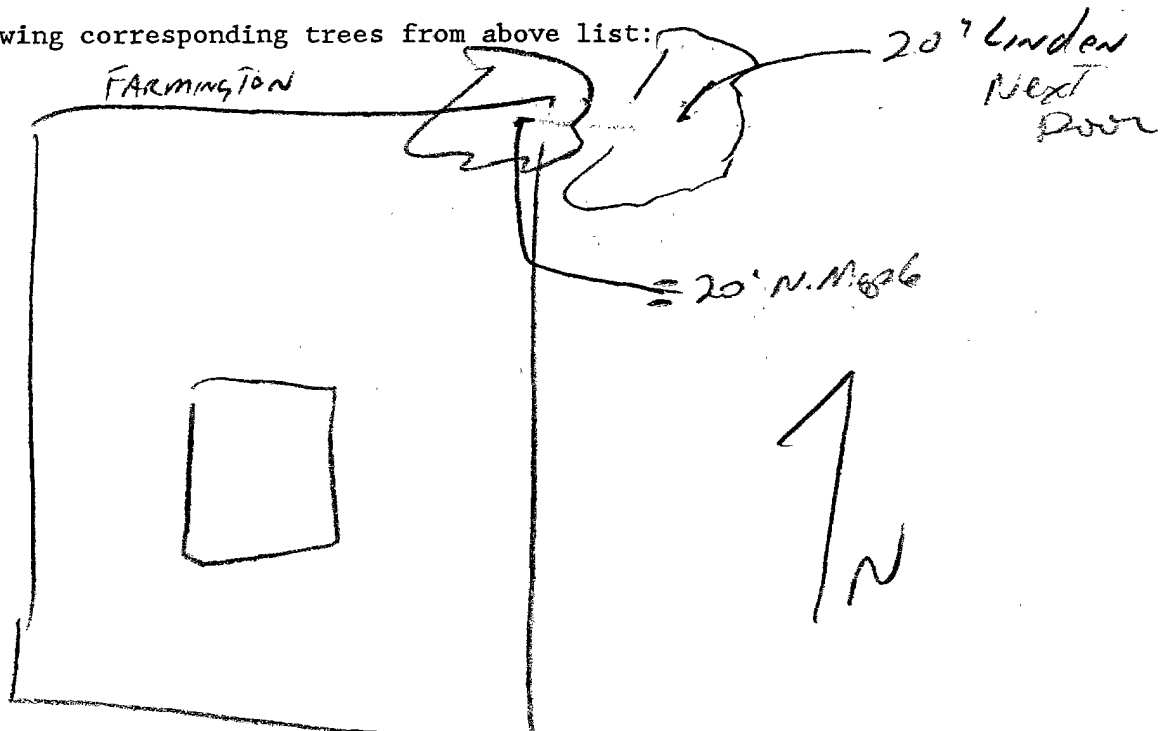

BEAVERTON TREE INVENTORY

H3

ADDRESS: 13000 Farmington

CROSS STREETS: West Side of Stott

LOT SIZE: _____

Number of trees over 3" DBH
(DBH: Diameter at breast height)
Formula for DBH

Diameter = Circumference divided by pi (3.1416)

- Species:
- | | |
|----------------------------|-----|
| 1. All Potential Hosts are | |
| 2. | 8. |
| 3. | 9. |
| 4. | 10. |
| 5. | 11. |
| 6. | 12. |
| 7. | 13. |
| | 14. |

Groves - number of trees _____ Average DBH _____
Number of Street Trees _____
Define street trees _____

Draw lot showing corresponding trees from above list:

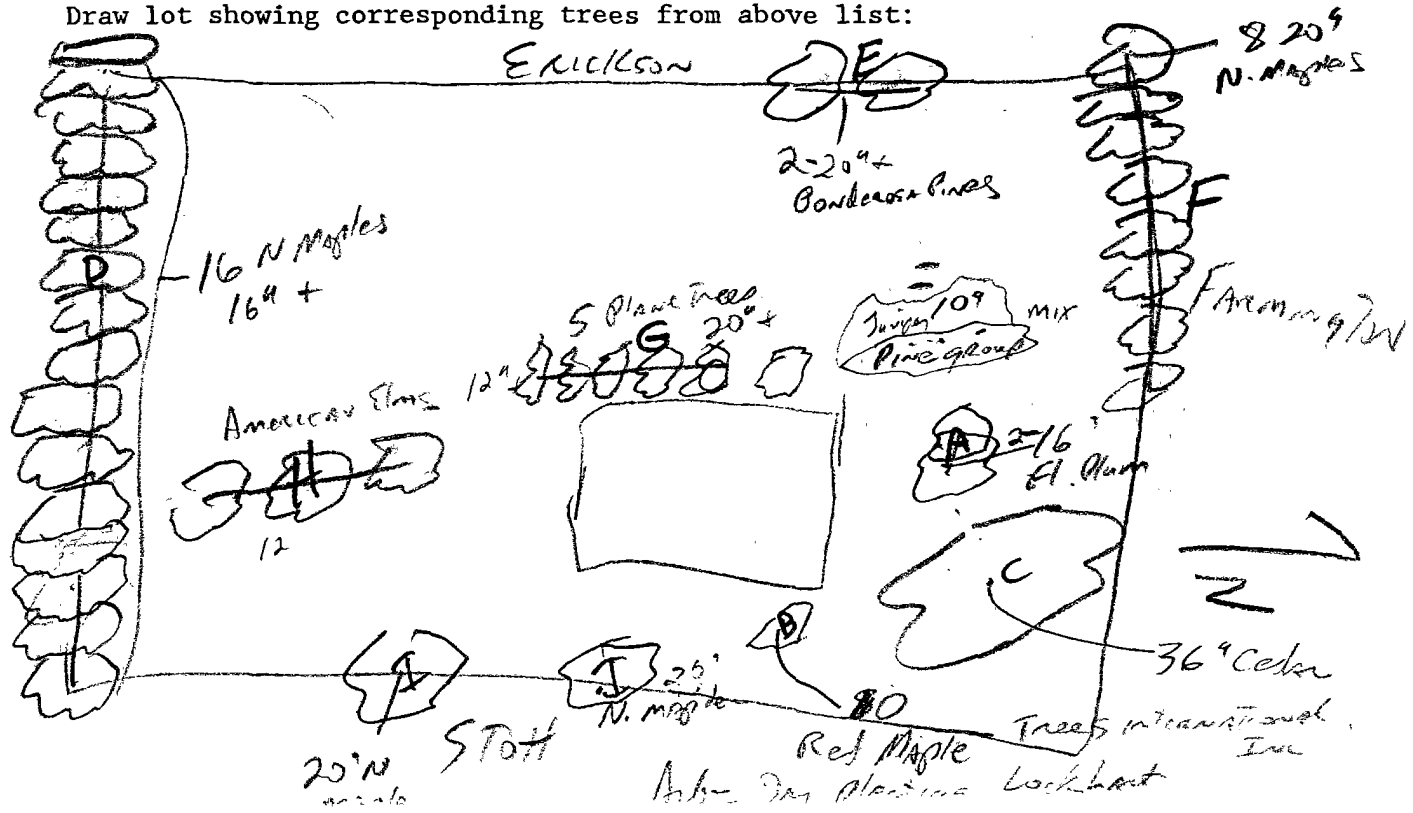

BEAVERTON TREE INVENTORY
TREE/GROVE HISTORICAL RATING SHEET

RATING SCALE:

1. - No historical value.
Age 20 years or under.
2. - Little historical value.
Age 20 years or over.
3. - Some historical value.
Age 50 years or over.
4. - Has historical value
Age 80 years or over.
5. - Has significant historical value.
Age 100 years or over.

CONDITION ASSESSMENT:

1. - Poor condition
Unhealthy with parts dead
or dying.
2. - Fair condition - OK health
but needing care.
3. - Good condition - Healthy.
(May still need care)

	<u>AGE</u>	<u>CONDITION</u>
I	3	2
H	3	2
A	2	3
B	1	3
C	3	3
D	3	2
E	4	2
F	3	2
G	2 (30yrs+)	3
	<u>RATING</u>	<u>RATING</u>

LOCATION 13000 Farmington

TREE/GROVE HISTORICAL ANALYSIS:

- 1) Tree/Grove association with historic figures, events or significantly associated with a location, place or structure.

Comments: Arbor day / Earth day ceremony tree circa 1986

Merle Davis early respected teacher
in Beaverton. Handcupping of an
age that it was probably planted
with original structure

- 2) Tree/Grove association with general growth and development of the City.

Comments: Trees are associated with
structure of historic importance
in Beaverton

TOTAL

<u>3</u>	_____	_____
<u>3</u>	_____	_____
<u>6</u>	_____	_____

Historic trees # 6

BEAVERTON TREE INVENTORY

ADDRESS: 8405 Creekside Place
FANNING HOUSE

CROSS STREETS: _____

LOT SIZE: _____

Number of trees over 3" DBH
(DBH: Diameter at breast height)
Formula for DBH

Diameter = Circumference divided by pi (3.1416)

Potential Historic

Species:

- 1. Cottonwood 36"
- 2. Fir 36" (Doug)
- 3. Gambrosia Pine 20" } NOT in Good Condition
- 4. 8.
- 5. 10.
- 6. 11.
- 7. 12.
- 8. 13.
- 9. 14.

Groves - number of trees _____ Average DBH _____

Number of Street Trees

Define street trees

Draw lot showing corresponding trees from above list:

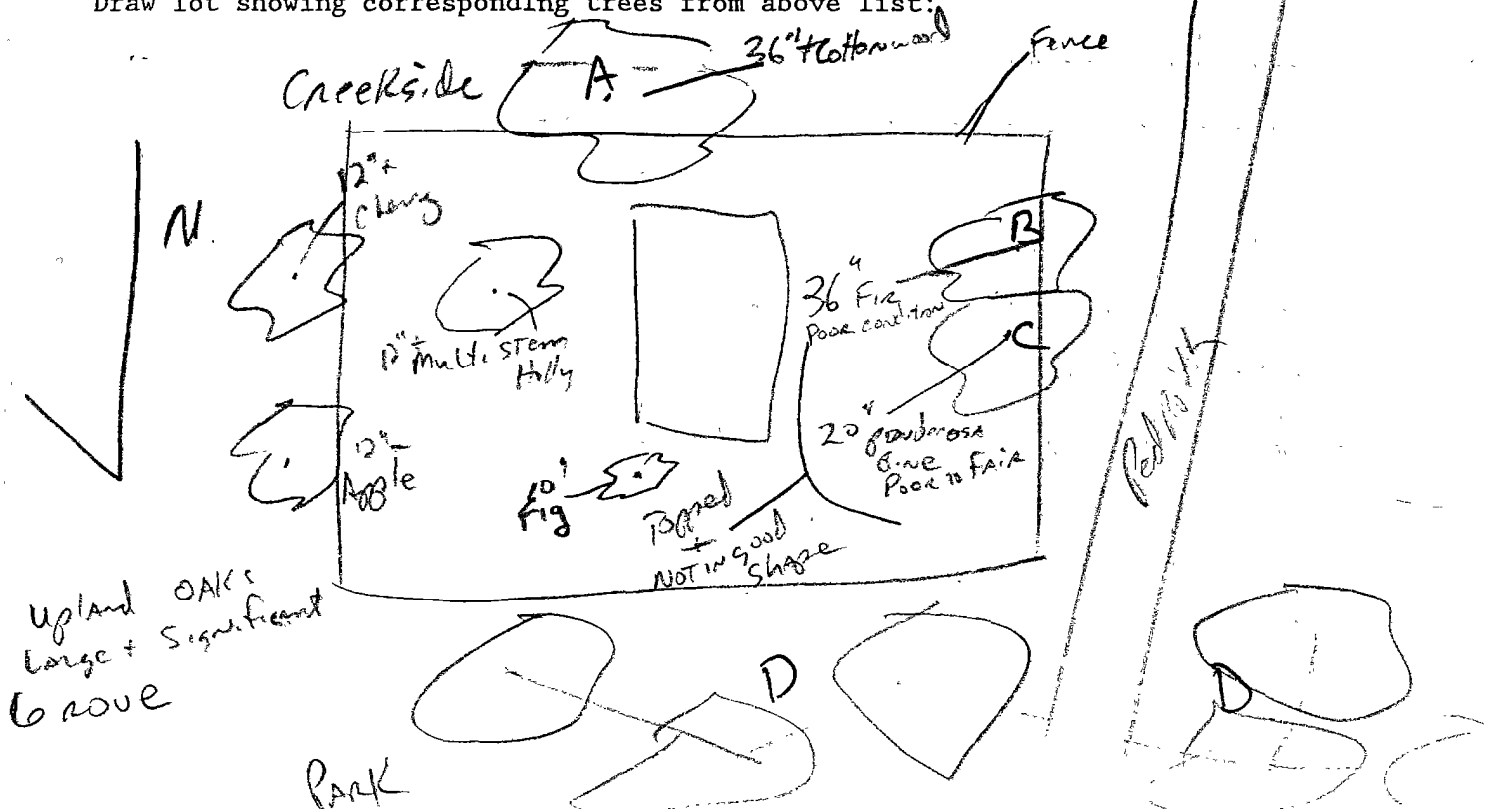

BEAVERTON TREE INVENTORY
 TREE/GROVE HISTORICAL RATING SHEET

RATING SCALE:

- 1. - No historical value.
Age 20 years or under.
- 2. - Little historical value.
Age 20 years or over.
- 3. - Some historical value.
Age 50 years or over.
- 4. - Has historical value
Age 80 years or over.
- 5. - Has significant historical value.
Age 100 years or over.

CONDITION ASSESSMENT:

- 1. - Poor condition
Unhealthy with parts dead
or dying.
- 2. - Fair condition - OK health
but needing care.
- 3. - Good condition - Healthy.
(May still need care)

	<u>AGE</u>	<u>CONDITION</u>
A	<u>5</u>	<u>3</u>
B	<u>5</u>	<u>1</u>
C	<u>5</u>	<u>1</u>
D	<u>5</u>	<u>3</u>

LOCATION 8405 Creekside

TREE/GROVE HISTORICAL ANALYSIS:

RATING RATING RATING

- 1) Tree/Grove association with historic figures, events or significantly associated with a location, place or structure.

5 _____ _____

Comments: Douglas Fir and Pine associated with Fanno. Planted in association with 1876 centennial

- 2) Tree/Grove association with general growth and development of the City.

5 _____ _____

Comments: Fanno farm on registers of historic places - associated with pioneer days of Beaverton

TOTAL

10 _____ _____

The Committee agreed that the appearance of the house will be improved with the removal of the garage and were in favor of the proposal.

Ms. Maldonado MOVED for approval of HRC 2-91 (Methodist/Episcopal Church).

Mr. Grant SECONDED the motion.

The question was called and the motion CARRIED unanimously.

2. HISTORIC TREE INVENTORY

Ms. Smith explained that the Board of Design Review has adopted a list of significant trees in the City. She and Mr. Plamondon have reviewed the historical structures to see if there are trees on these sites that should be preserved along with the structure. Once the list is adopted, the owner will be required to obtain approval from the City to cut the trees down or to do major pruning on the trees. There are a total of six sites that ranked high enough to be put on the list. The only location which has received any objection from the property owners has been from the Sisters of St. Mary's. Their objection stems from the fact that they will be required to go through an added process. However, staff feels that the impact on the site will not be as significant as the owners anticipate.

Ms. Smith presented slides showing some of the trees proposed for the inventory. After approved by the Committee, the inventory will go to City Council as part of their consent agenda.

Mr. Grant MOVED for approval of the Historic Tree Inventory.

Ms. Maldonado SECONDED the motion.

The question was called and the motion CARRIED unanimously.

Further discussion with regard to the trees ensued pertaining to the notification given to the property owners, what it means to the property owner to be on the list, and possible financial aid with the maintenance of the trees on the list.

MISCELLANEOUS

Ms. Smith indicated that she has arranged for a presentation to be given to the Committee on the architectural styles and character of the historic buildings in the City. This is scheduled for the next meeting.

The Committee's role in the Beaverton Centennial to be held in 1993 will be defined at a future meeting.

ADJOURNMENT: 7:20 p.m.

page
inadvertently
omitted
from
AB 91-118
attachments